

REV	2	CONTENT	CHK	DATE
V0.0		CONTENT	MYZ	21.06.05

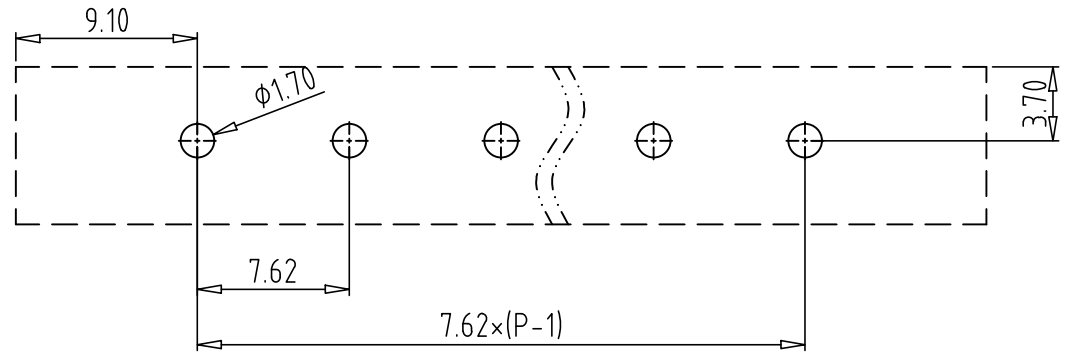

PCB LAYOUT

**Electrical :**

	<b>UL</b>	<b>IEC</b>
1. Rated Voltage :	300V	400V
2. Rated Current :	15A	20A
3. Withstanding Voltage :	AC1600V/1Min.	
4. Operating Temperature :	-40°C~+105°C	
5. RoHS Compliance		
6. Safety Approval :	cRoHS CE	
7. "★" is the key quality control point		

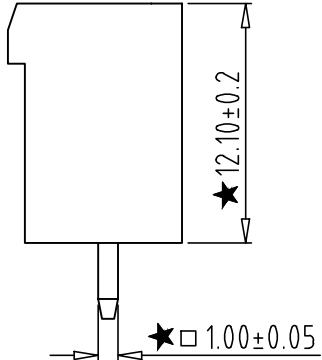
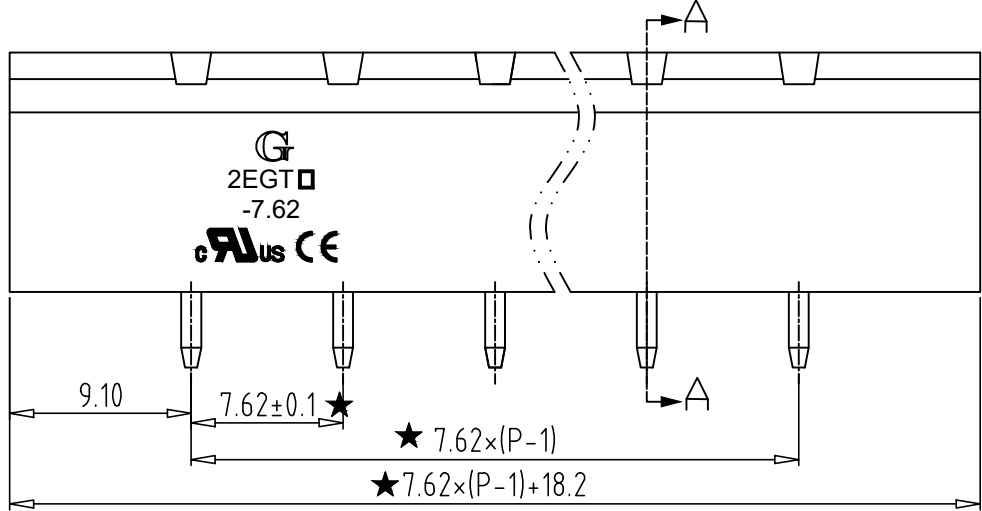
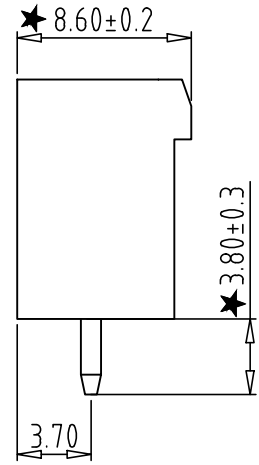

2EGTVM - 7.62 -XXP - X X - 100

① ② ③ ④ ⑤ ⑥

- ① Series NO.    ④ 1 Single Pitch  
                        2 Double Pitch
- ② Pitch                    ⑤ Color: 1 Grey  
                                  2 Blue  
                                  3 Black  
                                  4 Green  
                                  5 Orange  
                                  6 Red  
                                  7 Transparent  
                                  8 Yellow  
                                  9 White
- ③ Poles  
02 02Contacts  
03 03Contacts  
...  
24 24Contacts
- ⑥ Customer Request: 100--Standard

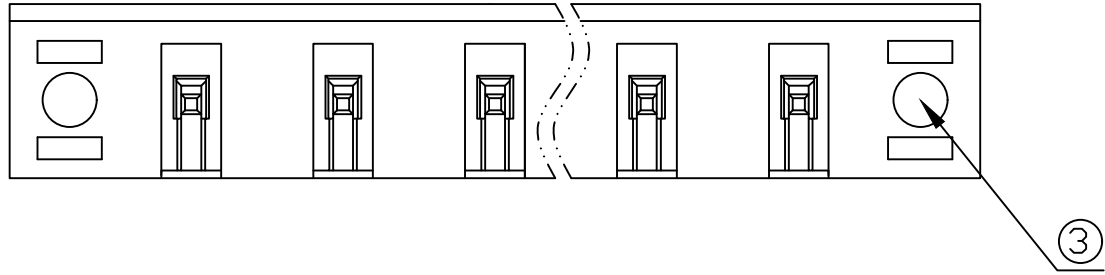
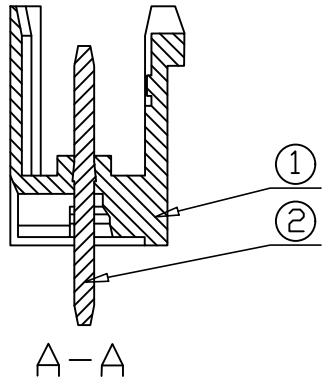

3	NUT	XX	2	BRASS	/
2	PIN HEADER	XX	P	BRASS	Tin Plated
1	HOUSING	XX	1	PA66 UL94V-0	SEE NOTE
ITEM	NAME OF PART	NO. OF PART	Q'TY	MATERIAL	NOTE
DWG.	MYZ	DATE	21.06.05	SIZE	A4 UNITS mm SHEET/OF 1/1
CHK.	DATE			SCALE	1:1
APP.	DATE			NAME	2EGTVM-7.62-XXP-XX-100

Total Pitch Tolerances in mm											Nominal dimension range in mm															
over 0	over 30	over 53	over 70	over 90	over 115	over 150	over 250	over 350	over 500	over 700	over 1000	0	30	53	70	90	115	150	200	250	320	0	over 10	0	100	over 150
±0.18	±0.20	±0.25	±0.3	±0.35	±0.44	±0.60	±0.70	±0.85	±0.20	±0.25	±0.30	±0.35	±0.44	±0.55	±0.70	±0.80	±0.90	0.2	0.3	0.3	0.2	0.3	0.5			