

| | | | |
|------|---------|-----|----------|
| REV | CONTENT | CHK | DATE |
| VO.0 | CONTENT | MYZ | 21.06.05 |

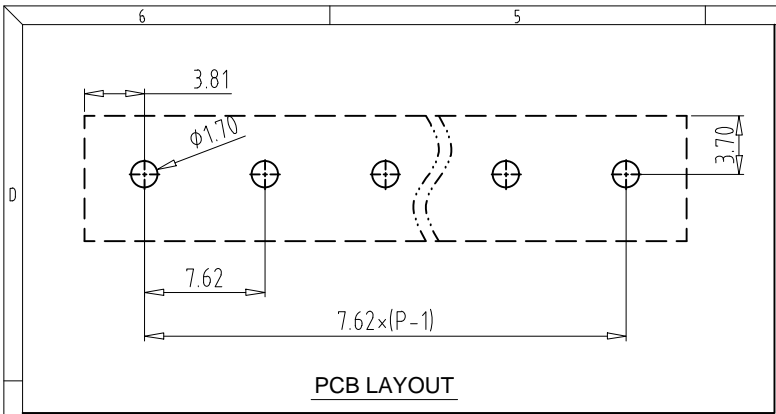

Electrical :

- 1. Rated Voltage : **UL** 300V **IEC** 400V
- 2. Rated Current : 15A 20A
- 3. Withstanding Voltage : AC1600V/1Min.
- 4. Operating Temperature : -40°C~+105°C
- 5. RoHS Compliance
- 6. Safety Approval : **eRus CE**
- 7. "★" is the key quality control point

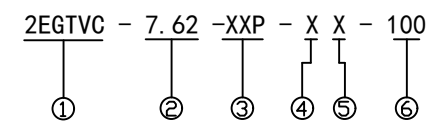
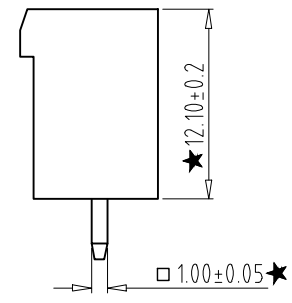
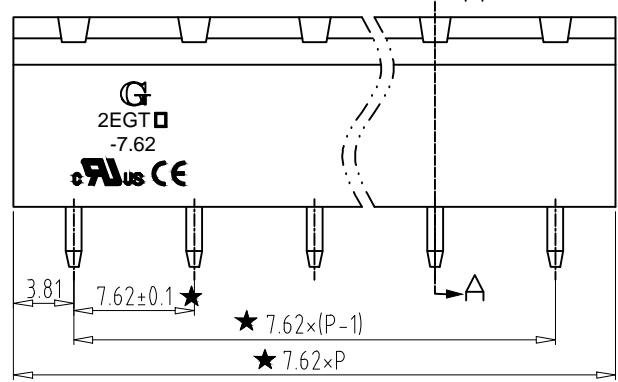
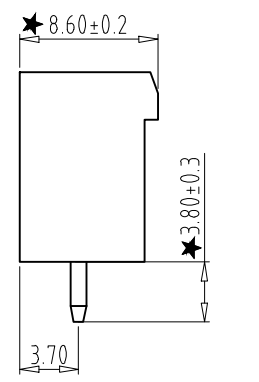

- ① Series NO. ④ 1 Single Pitch
 2 Double Pitch
- ② Pitch ⑤ Color: 1 Grey
 2 Blue
 3 Black
 4 Green
 5 Orange
 6 Red
 7 Transparent
 8 Yellow
 9 White
- ③ Poles
02 02Contacts
03 03Contacts
...
24 24Contacts
- ⑥ Customer Request: 100--Standard

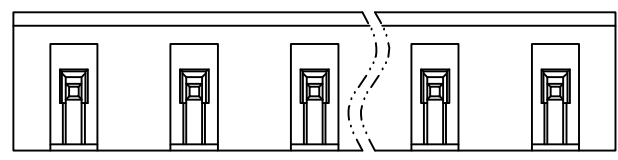
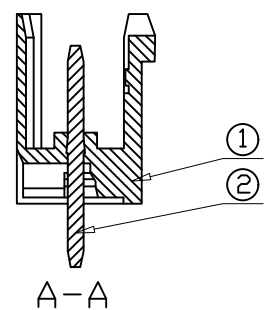

| Total Pitch Tolerances in mm | | | | | | | | Nominal dimension range in mm | | | | | | | | | | ⊥ | ≡ | - | // | | | | | | |
|------------------------------|-------|-------|------|-------|-------|-------|-------|-------------------------------|-------|-------|-------|-------|-------|-------|-------|-------|-------|------|------|------|------|------|------|------|---|-----|-----|
| over | over | over | over | over | over | over | over | over | over | over | over | over | over | over | over | over | over | over | over | over | over | over | over | over | 0 | 100 | 150 |
| 0 | 30 | 53 | 70 | 90 | 115 | 150 | 250 | 0 | 30 | 53 | 70 | 90 | 115 | 150 | 200 | 250 | 0 | 10 | 10 | 10 | 0 | 100 | 150 | | | | |
| to | to | to | to | to | to | to | to | to | to | to | to | to | to | to | to | to | to | to | to | to | to | to | | | | | |
| 30 | 53 | 70 | 90 | 115 | 150 | 250 | 350 | 30 | 53 | 70 | 90 | 115 | 150 | 200 | 250 | 10 | 10 | 10 | 10 | 100 | 100 | 150 | | | | | |
| ±0.18 | ±0.20 | ±0.25 | ±0.3 | ±0.35 | ±0.44 | ±0.60 | ±0.70 | ±0.85 | ±0.20 | ±0.25 | ±0.30 | ±0.35 | ±0.44 | ±0.55 | ±0.70 | ±0.80 | ±0.90 | 0.2 | 0.3 | 0.3 | 0.2 | 0.3 | 0.5 | | | | |

| | | | | | |
|---|--------------|-------------|----------|-----------------------------|----------------|
| 2 | PIN HEADER | XX | P | BRASS | Tin Plated |
| 1 | HOUSING | XX | 1 | PA66 UL94V-0 | SEE NOTE |
| ITEM | NAME OF PART | NO. OF PART | Q'TY | MATERIAL | NOTE |
| DWG. | MYZ | DATE | 21.06.05 | SIZE A4 UNITS mm | SHEET/OF 1 / 1 |
| CHK. | DATE | | | SCALE 1:1 | |
| APP. | DATE | | | | |
| | | | | NAME 2EGTVC-7.62-XXP-XX-100 | |
| 宁波冠泰电子有限公司 NINGBO GOLTEN ELECTRONICS CO., LTD. | | | | DWGNO. XXXX | |