

Material :

- (a) Housing : PA6T+GF(UL94V-0)
- (b) Pin Header : Brass , Tin Plated

Electrical :

- 1.Rated Voltage : UL 300V IEC 250V
- 2.Rated Current : 10A 12A
- 3.Reflow Soldering
- 4.Soldering Temperature : 265 °C±10°C/5 Sec
- 5.Operating Temperature : -40 °C~+105 °C
- 6.RoHS Compliance
- 7.Safety Approval :
- 8.Undimensioned Tolerances:

Pitch Range In mm			Nominal Dimension Range In mm					-	∩	□
≤6	6 ~ 10	10 ~ 24	≤30	30 ~ 60	60 ~ 100	100 ~ 150	>150	0.05/10		
±0.10	±0.15	±0.25	±0.20	±0.30	±0.50	±0.70	±1.00	±0.1°		

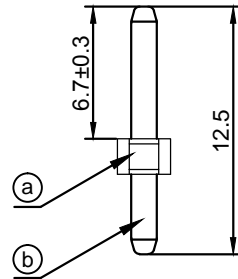

GT332J - 5.0 - XXP - X X - 00 AH

① ② ③ ④ ⑤ ⑥ ⑦

- ① Series No.
- ② Pitch
- ③ Poles
02 02Contacts
03 03Contacts
...
24 24Contacts
- ④ 1 Single Pitch
2 Double Pitch
- ⑤ Color: 1 Grey
2 Blue
3 Black(Standard For AH)
4 Green
5 Orange
6 Red
7 Transparent
8 Yellow
9 White
- ⑥ Customer Request : 00--Standard
- ⑦ AH--Standard(PA6T+GF)

DETACHED LISTS	Grolten NINGBO GOLTEN ELECTRONICS CO., LTD.		宁波冠泰电子有限公司		
	APPD: MA_8/13/16'	CHKD: Yu_8/12/16'	PART NO. GT332J-5.0-XXP-XX-00AH		
	DRFT: Chen_8/11/16'	DRAWING NO.		REV	1
	 THIRD ANGLE PROJECTION		MM (INCH)	DO NOT SCALE DRAWING	SHEET
				SCALE	1/1

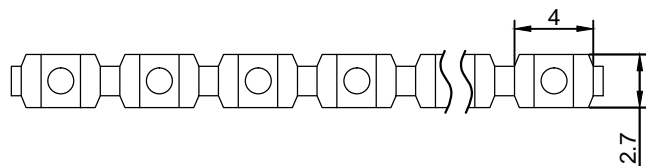
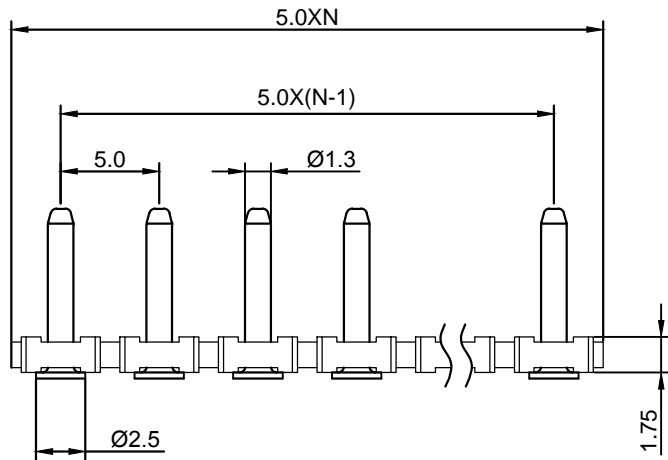

Material :

- Ⓐ Pin Header : Brass , Tin Plated
- Ⓑ Housing : LCP(UL94V-0)

Electrical :

- 1.Rated Voltage : 300V UL IEC 250V
- 2.Rated Current : 10A IEC 12A
- 3.Reflow Soldering
- 4.Soldering Temperature : 265 °C±10°C/5 Sec
- 5.Operating Temperature : -40 °C~+105 °C
- 6.RoHS Compliance
- 7.Safety Approval :
- 8.Undimensioned Tolerances:

Pitch Range In mm		Nominal Dimension Range In mm					—	∩	□
≤6	6 ~ 10	10 ~ 24	≤30	30 ~ 60	60 ~ 100	100 ~ 150	>150	0.05/10	
±0.10	±0.15	±0.25	±0.20	±0.30	±0.50	±0.70	±1.00	±0.1°	

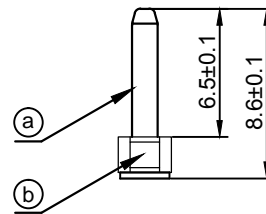

GT332J - 5.0 - XXP - 1 3 - 00 TH

① ② ③ ④ ⑤ ⑥ ⑦

- ① Series No.
- ② Pitch
- ③ Poles
- ④ 1 Single Pitch
2 Double Pitch
- ⑤ Color: 1 Grey
2 Blue
3 Black(Standard For AH)
4 Green
5 Orange
6 Red
7 Transparent
8 Yellow
9 White
- ⑥ Customer Request : 00--Standard
- ⑦ TH--SMD

DETACHED LISTS	Grolten 宁波冠泰电子有限公司 NINGBO GOLTEN ELECTRONICS CO., LTD.													
	APPD: MA_10/20/17'	PART NO. GT332J-5.0-XXP-XX-00TH												
	CHKD: Yu_10/20/17'													
	DRFT: Chen_10/20/17'													
 THIRD ANGLE PROJECTION		<table border="1"> <tr> <td>DRAWING NO.</td> <td>REV</td> <td>1</td> </tr> <tr> <td></td> <td>SHEET</td> <td>1/1</td> </tr> <tr> <td>MM (INCH)</td> <td>DO NOT SCALE DRAWING</td> <td>SCALE</td> </tr> <tr> <td></td> <td></td> <td>1/1</td> </tr> </table>	DRAWING NO.	REV	1		SHEET	1/1	MM (INCH)	DO NOT SCALE DRAWING	SCALE			1/1
DRAWING NO.	REV	1												
	SHEET	1/1												
MM (INCH)	DO NOT SCALE DRAWING	SCALE												
		1/1												