

Material :

- (a) Housing : PA66(UL94V-0)
- (b) Pin Header : Brass , Tin Plated
- (c) Nut : Brass

Electrical :

- 1. Rated Voltage : 300V UL IEC
- 2. Rated Current : 15A 320V 20A
- 3. Withstanding Voltage : AC1600V/1Min.
- 4. Operating Temperature : -40°C~+105°C
- 5. RoHS Compliance
- 6. Safety Approval :
- 7. Undimensioned Tolerances:

Pitch Range In mm		Nominal Dimension Range In mm					-	∩	∇
≤6	6 ~ 10	10 ~ 24	≤30	30 ~ 60	60 ~ 100	100 ~ 150	>150	0.05/10	
±0.10	±0.15	±0.25	±0.20	±0.30	±0.50	±0.70	±1.00	±0.1°	

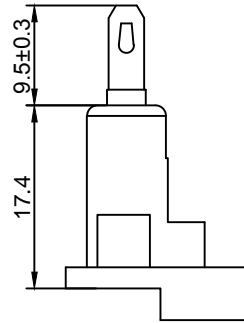
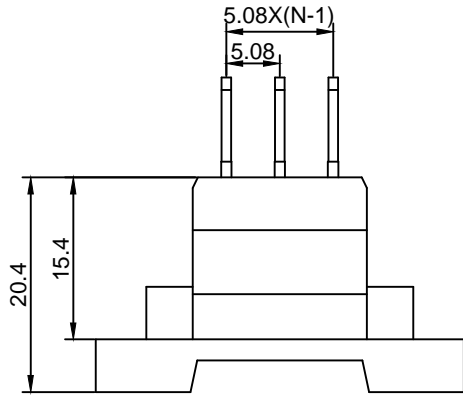
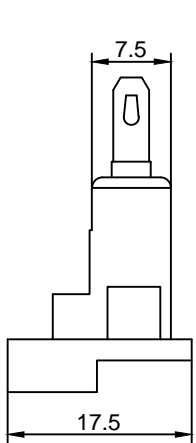

2EGTVC - 5.08 - XXP - CB - X X - XX AH

① ② ③ ④ ⑤ ⑥ ⑦ ⑧

- ① Series No.
- ② Pitch
- ③ Poles
02 02Contacts
03 03Contacts
...
24 24Contacts
- ④ CB--Wide Pin
- ⑤ 1 Single Pitch
2 Double Pitch
- ⑥ Color: 1 Grey
2 Blue
3 Black
4 Green(Standard For AH)
5 Orange
6 Red
7 Transparent
8 Yellow
9 White
- ⑦ Customer Request: 00--Standard
- ⑧ AH--Standard(PA66)

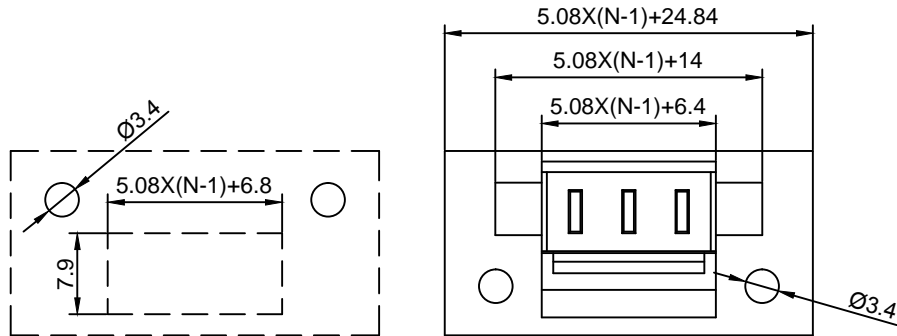

Grolten NINGBO GOLTEN ELECTRONICS CO., LTD.		宁波冠泰电子有限公司	
APPD: MA_6/13/15'	CHKD: Yu_6/12/15'	PART NO. 2EGTVC-5.08-XXP-CB-XX-00AH	
DRFT: Chen_6/11/15'	DRAWING NO.		REV 1
 THIRD ANGLE PROJECTION		MM (INCH)	DO NOT SCALE DRAWING
		SHEET 1/1	SCALE 1/1